

Vessel: Multi-Purpose Work Boat / Multi Cat 1908

Name: MURJAN 40

**GENERAL**

Type of Vessel	:Multi-Purpose Work Boat Barge
Basic Functions	:Dredging, Towing, Pushing, Bouy and Anchor Handling, Survey, Crane Loads
Builder	:DAMEN Shipyards Hardinxveld
Place	:Netherlands
Build Date	:August 2017
Delivery Date	:September 2017
Classification	:Bureau Veritas I * Hull • MACH Special Service/Workboat Coastal Area
Equipment	:1 Main Anchor, Chain Diameter 17.5 mm, Steel Quality Q2
Hull Material	:Steel

BOAT REGISTRY

Ship's Name	:Murjan 40
BV Registration Number	:24235U
Flag	:Saudi Arabia
Yard	:518527
Official Number	:4316

DIMENSIONS AND WEIGHT

Gross Tonnage 69	:98 tons
Net Tonnage 69	:29 tons
Overall Length	:18.7 m
LPP	:18.21 m
Breadth	:8 m
Depth	:2.75 m
Draught	:2.23 m
Freeboard	:870 mm

PROPULSION SYSTEM

Main Engines	:2x Caterpillar C18 TA/B
Total Power	:894 bkW (1214 bhp) at 1800 rpm
Gear Boxes	:2x Reintjes WAF 264L, 4.5:1
Propellers	:2x Kaplan II Fixed Pitch Propellers
Nozzles	:2x 1350 mm Van de Giessan "Optima" w/ Stainless Steel Innerring
Steering Gear	:Power Hydraulic 2x 45° w/ Rudder Indicator

TANK CAPACITY

Fuel Oil	:7.5 m ³ , 6.3 tons(m)
Additional Fuel Capacity	:45.5 m ³ , 38.2 tons(m)
Fresh Water	:1.1 m ³ , 0.9 tons(m)
Lubrication Oil	:0.8 m ³ , 0.7 tons(m)
Dirty Oil	:0.9 m ³
Bilge Water	:0.8 m ³
Sewage	:0.9 m ³
Fresh Water Ballast Aft	:12.9 m ³
Fresh Water Ballast Front	:9 m ³

PERFORMANCE

Bollard Pull Ahead	:13.7 tons
Speed	:9.2 knots

BOLLARD PULL RECORD

Engines	:Full Power
Water Depth	:9 m
Waves	:0 m
Wind	:8/130 knots/deg
Wire rope length	:150 m
Current	:1/300 knots/deg
Draft	:1.67 Aft 1.23 Fwd

ANCHOR EQUIPMENT

Anchor Weight	:105 kg
Spare Anchor	:48 kg
Total Chain Length	:100 m
Chain Diameter	:16 mm (Short-link)
Chain Quality	:U2 (Class)

NAUTICAL AND COMMUNICATION EQUIPMENT

Searchlight	:Pesch 500W 24 V
AIS	:Furuno FA-150
Radar	:Furuno FR-8062
Compass	:Kotter Type w/ Electric Repeater
GPS	:Furuno GP-32
Echosounder	:Furuno LS-6100 w/ LCD
VHF	:Sailor 6248
Handheld VHF	:Jotron TR-20

GENERATOR

Maker	:Stamford
Engine Type	:Caterpillar C4.4 NA
Capacity	:47 kVA
Voltage	:230/400 V
Phase(s)	:3
Frequency	:50 Hz
Number Installed	:1 Pcs

HYDRAULIC POWER PACK AND HOSES

Maker	:Damen Dredging Equipment
Type	:600PP, Tier 3
Diesel Engine	:Radiator Cooled Caterpillar C15
Power	:403 kW at 2,100 rpm
Hydraulic Pump	:Parker PV360, 630 L/min. at 275 bar
Fuel Tank	:650 L
Length of Hose	:40 m (2x 20m)

JET PUMP AND HOSES

Maker	:Damen Dredging Equipment
Type	:DJP300/9.8
Diesel Engine	:Iveco
Power	:175 kW
Capacity	:300 m ³ /h at 9.8 bar
Fuel Tank Contents	:1000 L (Double Walled Tank)
Length of Hose	:40 m (2x 20m)
Max Working Pressure	:12 bar

SUBMERSIBLE DREDGE PUMP

Maker	:Damen Dredging Equipment
Type	:DOP 250
Drive	:Hydraulic Motor Via Gearbox
Max. Available Power at Pump Shaft	:Approx. 195 kW
Materials	:Pump Casing: Ni-Hard 4
Impeller	:Bainitic Nodular
Shaft	:42CrMo4
WPSS	:Ni-Hard 4



ACCOMODATION

Air-conditioning	:Wheelhouse
Facilities	:Dayroom, Pantry, Sanitary, Work Shop

HYDRAULIC CRANE

Maker	:Heila HLRM 80-2S
Lifting Capacity	:6.7 tons (metric at 10.07 m)
Winch Lifting Power	:10.0 tons w/ Double Line Use
Winch Wire Length	:45 m
Bow Roller Width	:Approx. 2500 mm
Bow Roller Diameter	:Approx. 900 mm
BR Safe Working Load	:30 tons



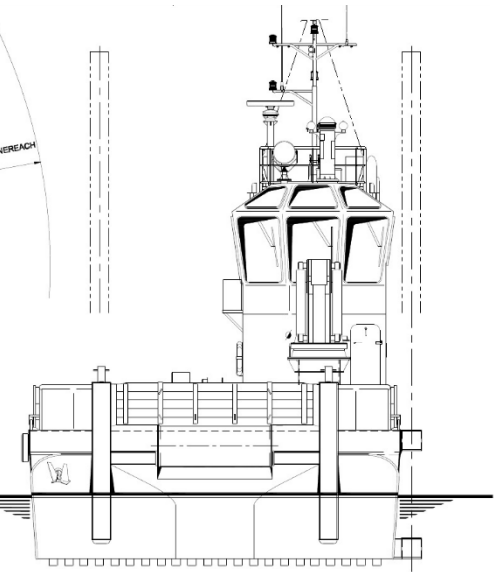
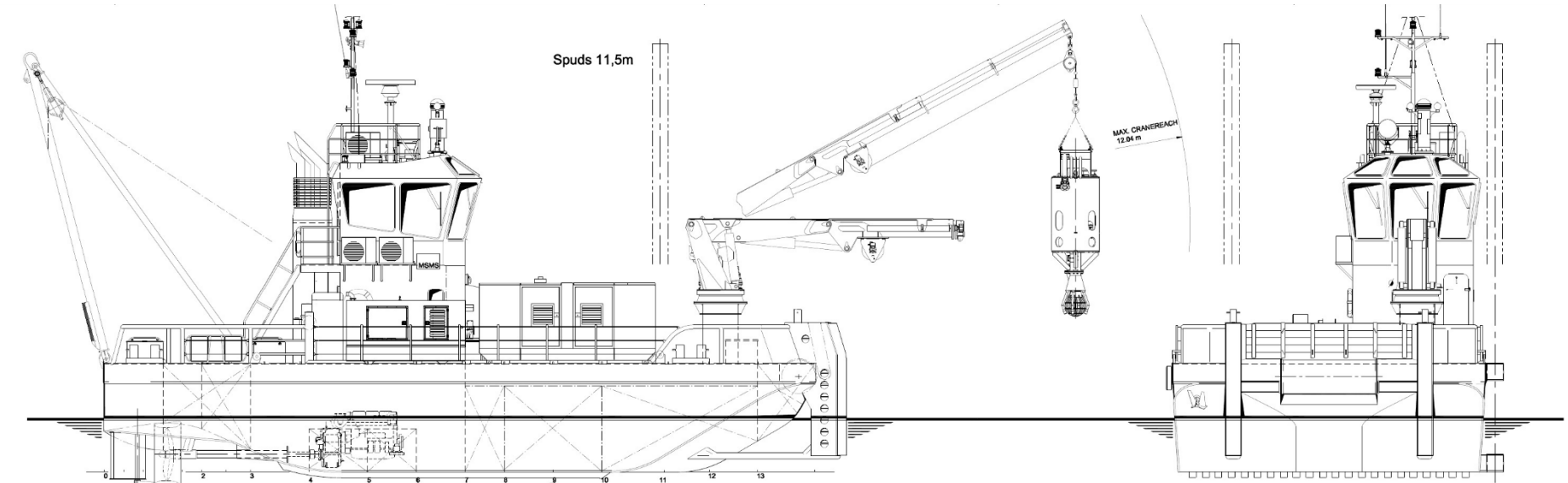

Maindeck

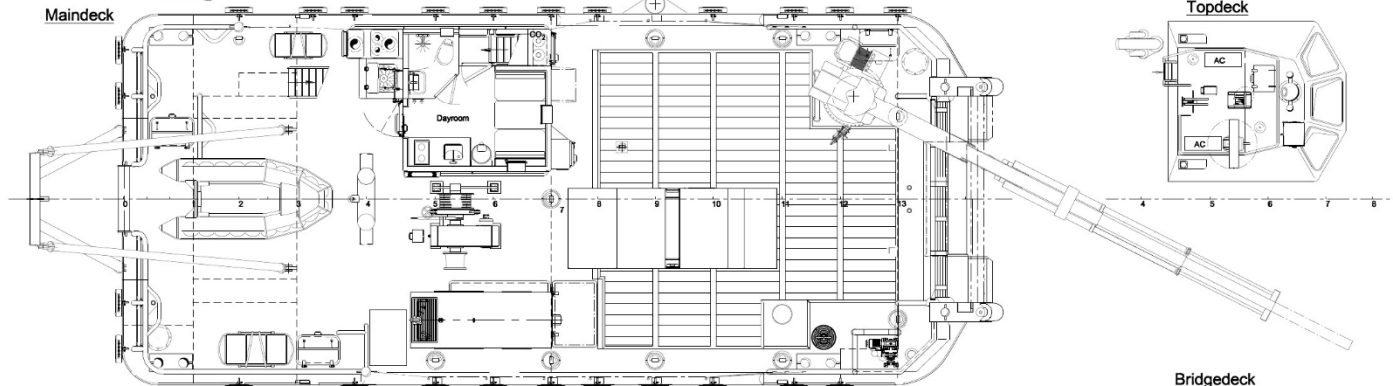

Topdeck

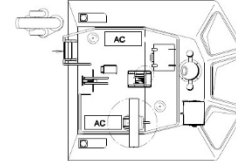

MURJAN 40

Below Maindeck

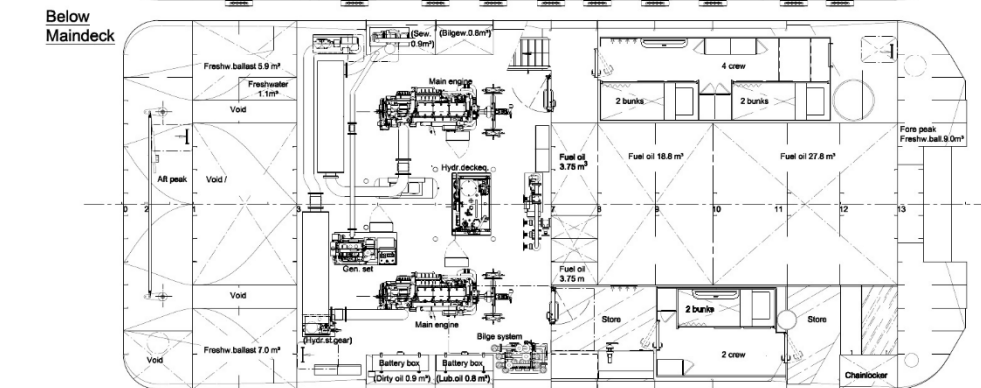

Bridgedeck

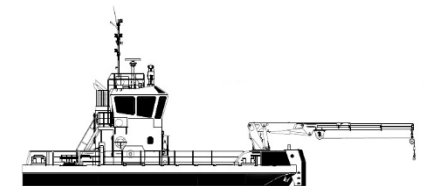
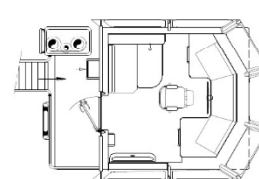

Main dimensions:

Length o.a.	18.91 m
Beam o.a.	8.06 m
Depth at sides	2.75 m
Draught aft (approx.)	2.10 m

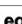
Items marked with  are optional equipment

