

Vessel: Rescue / Survey Boat**Name: KASHIF****GENERAL**

Type of Vessel	:Crew, Survey, Service Boat
Basic Functions	:Transport, Survey, Service Boat, Marine Equipment Towing
Builder	:Canadian Geo
Place	:United Arab Emirates
Build Date	:2014
Delivery Date	:2017
Hull Type	:Aluminum
Ventilation	:Air Conditioned

BOAT REGISTRY

Boat's Name	:Kashif
Flag	:Saudi Arabia
Official Number	:43890
Serial Number	:008063

DIMENSIONS AND WEIGHT

Length	:10 m
Width	:4 m
Breadth	:7.5 m
Depth	:0.91m
Gross Registered Weight	:10 tons

PROPULSION SYSTEM

Main Engines	:2x OXE
Engine Type	:Diesel
Total Power	:300 HP (2x 150 HP)
Speed	:50 knots

CAPACITY

Max. No of Persons on Board	:10 Persons
-----------------------------	-------------

NAUTICAL AND COMMUNICATION EQUIPMENT

Searchlight	:Den Haan Rotterdam DHR-180CB
Loudhailer	:Standard
Magnetic Compass	:Plastimo Offshore 105 BV-0062
Echo Sounder	:Furuno GP-1650F
VHF	:Cobra Marine

DECK EQUIPMENT

Fire Extinguisher	:Portable FE, 1 kg Dry Powder
Life Jackets	:10x Pcs
Life Raft	:1x Pcs
Life Buoys w/ Rope	:1x Pcs
Hand Flares	:2x Pcs
Emergency Batteries	:2x Pcs



KASHIF

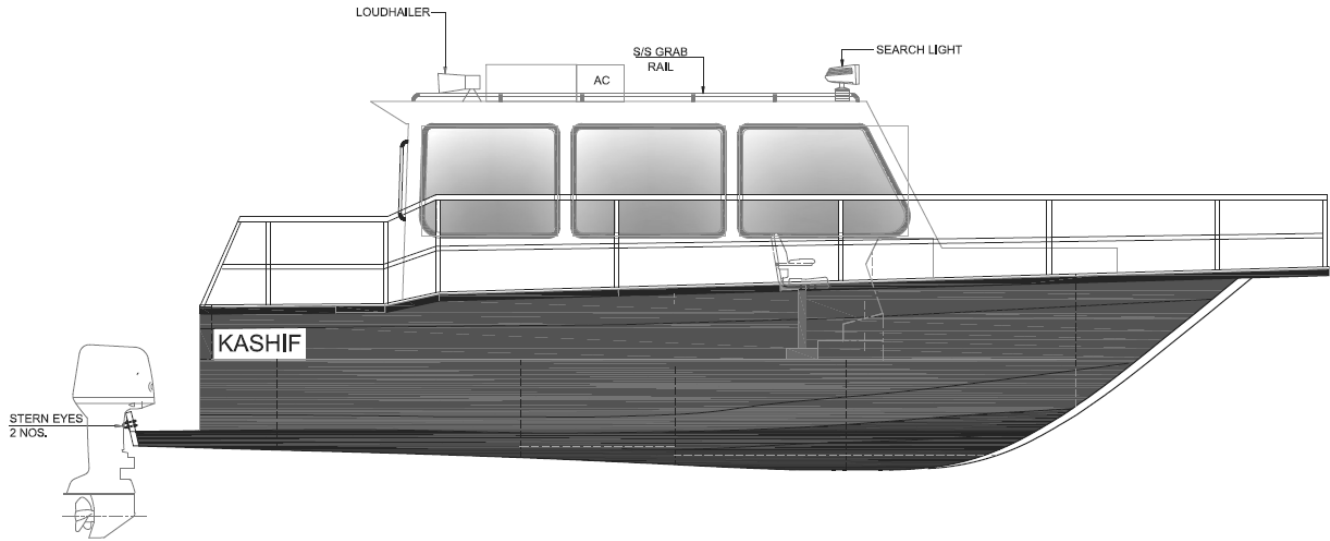

SIDE VIEW

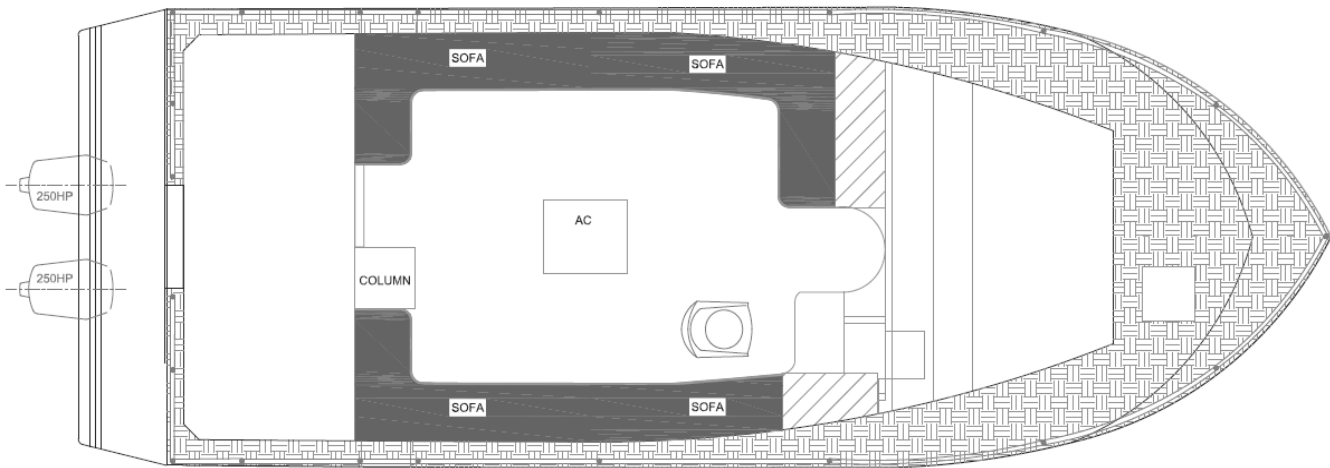

PLAN